

## • 8U - Vertical Configuration

### Features

- EMC integrated system in 19" rack mount
- Aluminum enclosure
- Dimension: 8U (H) x 84T (W) x 283mm (D)
- 3 fans in a pluggable 1 U fan unit
- 8-slot 6U CompactPCI backplane
- Front cage: 8-slot, 6U x 160mm
- Rear I/O: 8-slot, 6U x 80 mm
- 400 W ATX or 400 W cPCI power supply
- 1 x 5.25" and 2 x 3.5" device holders
- Customization is available



P/N: P-884283

### Mechanical Design

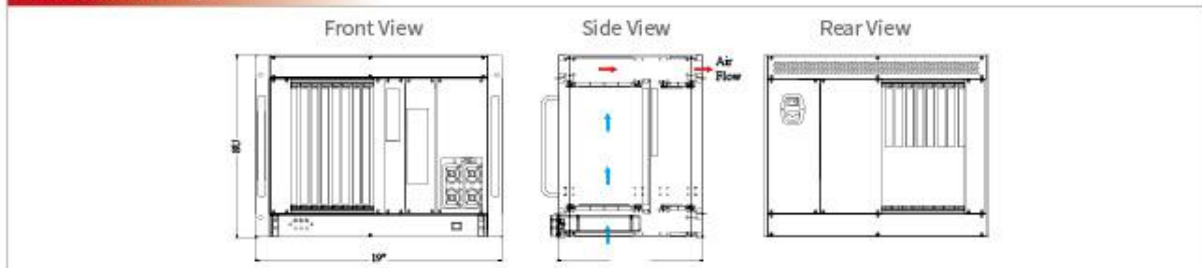

### Specifications

Fan Unit	Fan Mode	Bearing type	Nominal Voltage	DC 12 V
	Dimension	120 x 120 x 25 mm	Noise	40 dB
Backplane	8-slot 6U CompactPCI backplane			
Power Supply ATX type	Output power	400 W		
	Output voltage	+5V/18A, +12V/18A, +12V2/18A, -12V/0.8A, +3.3A/18A, +5vsb/2.5A		
	Input voltage	100 - 240 VAC	Frequency	50 - 60 Hz
Power Supply cPCI type	Output power	400 W (6U 8HP pluggable)		
	Output voltage	+5V/40A, +3.3V/20A, +12V/10A, -12V/3A		
	Input voltage	90 - 264 VAC	Frequency	47 - 63 Hz